



SEDE: Via Pini 135 41019 SOLERA (MO) TEL. 059-565878 FAX 059-565858 PEC palladium@palladium.it

PROGETTO URBANISTICO:
PROGETTO: PUA "MAGAZZINO COMUNALE" AMBITO AR.2.1
IL COMMITTENTE: VECA s.r.l.



ARCHITECTURE & DESIGN
ARCH. SARA COLUCCIELLO

ELABORATO: SEZIONE STRADALE E PARTICOLARE RECINZIONE
TAVOLA: 3
DATA: APRILE 2021
SCALA: 1:500
AGGIORNAMENTO: SETTEMBRE 2023

IL COMMITTENTE

IL PROGETTISTA

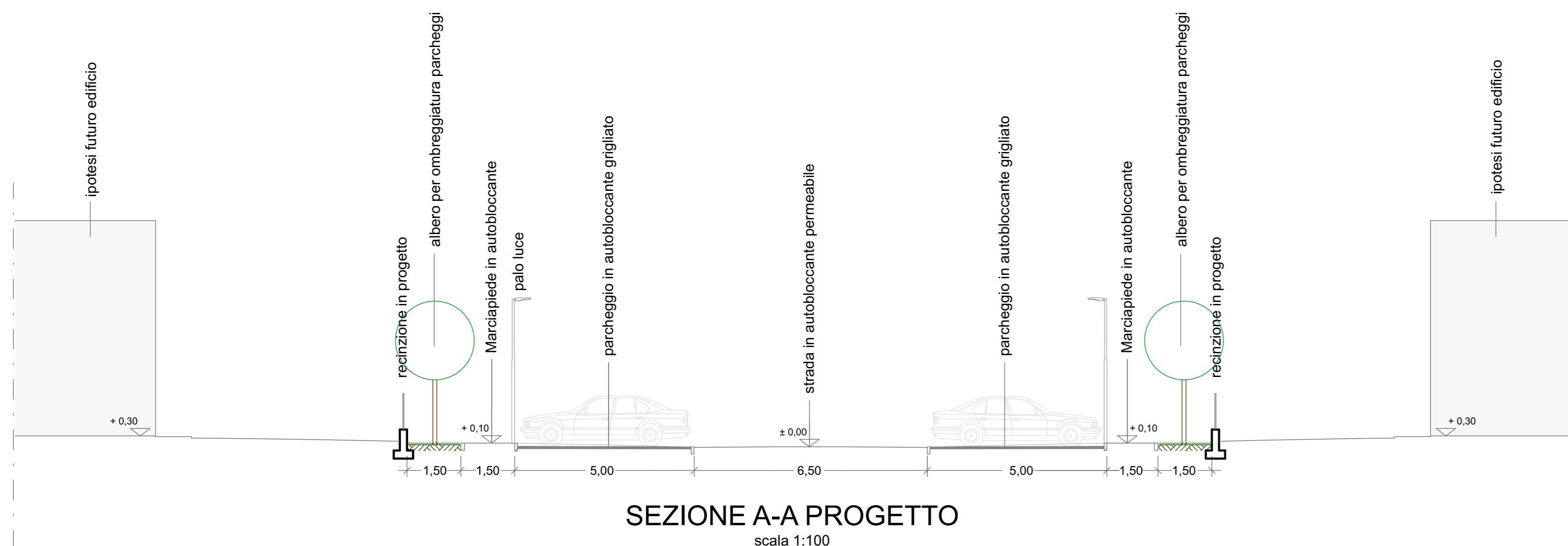
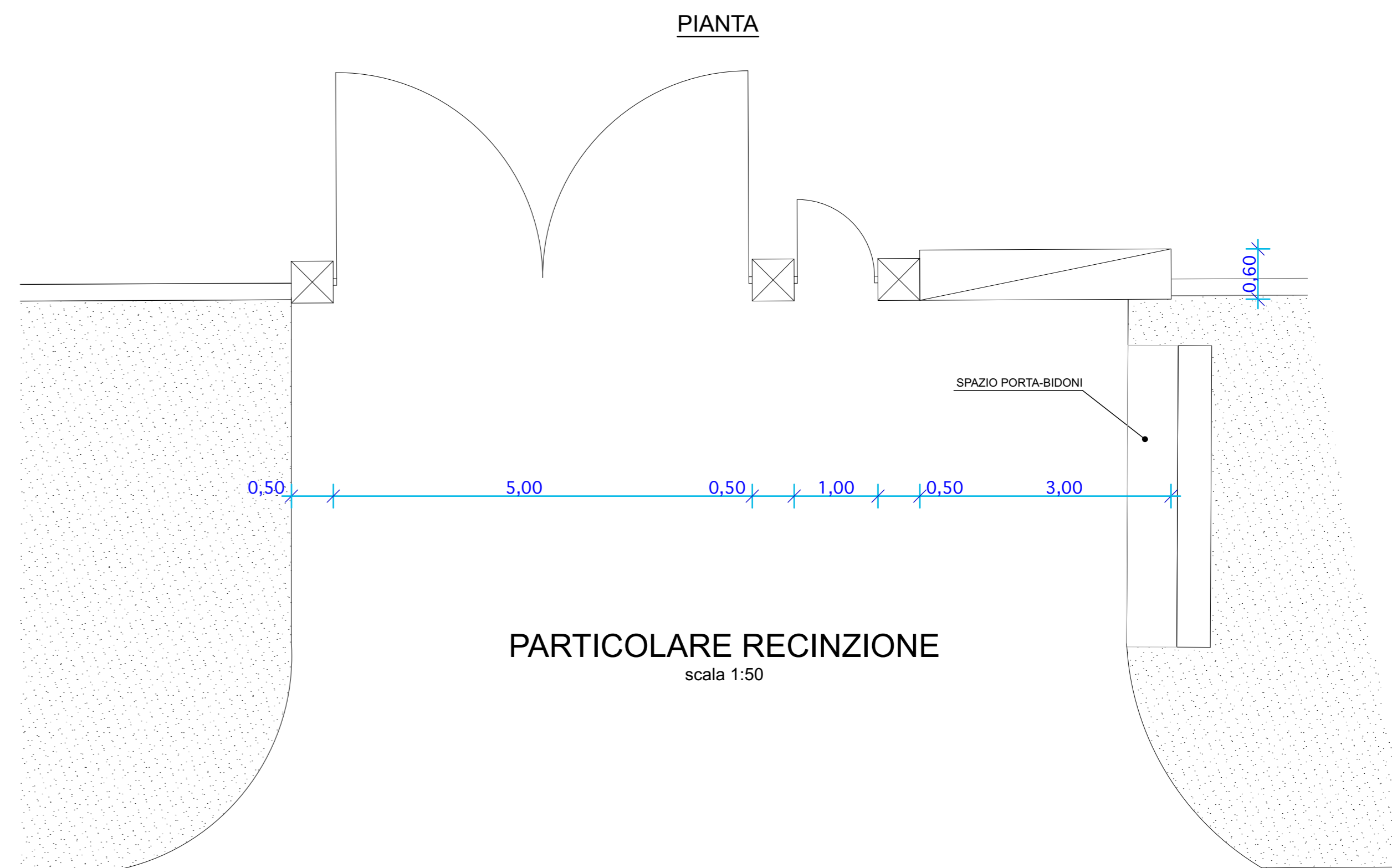
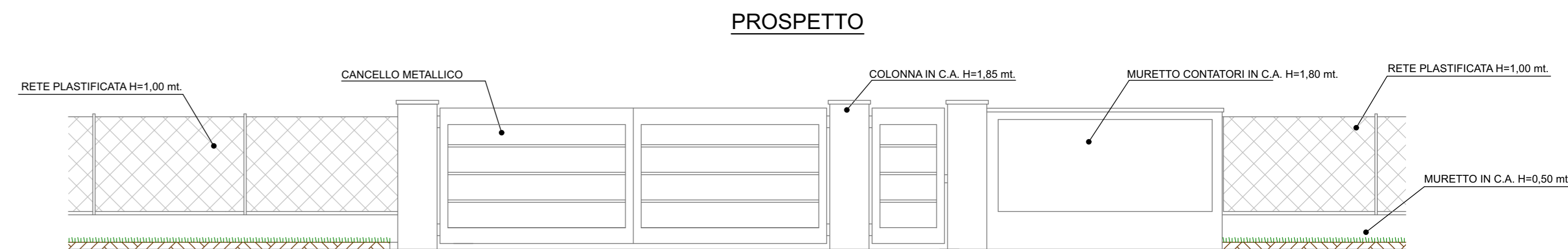
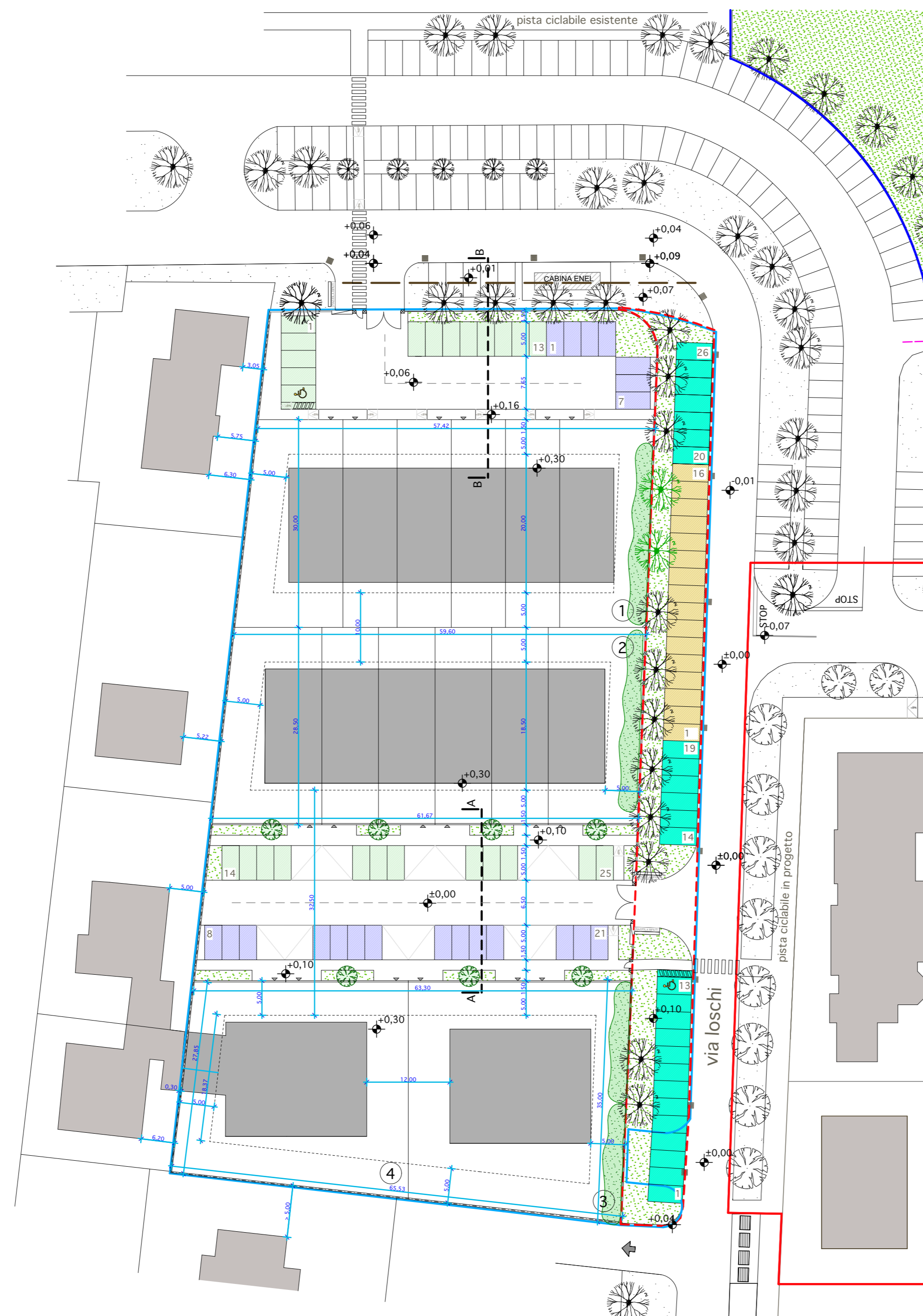

SEZIONE A-A PROGETTO
scala 1:100

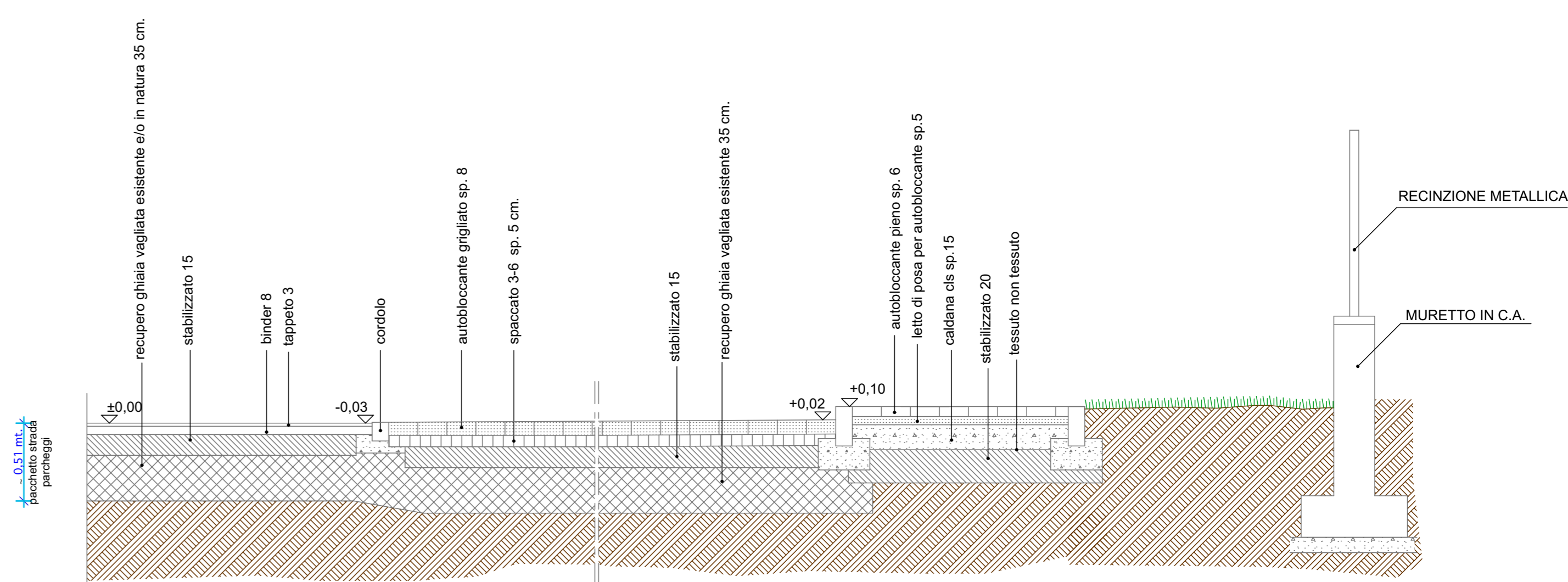

STRADA - PARCHEGGI - MARCIAPIEDE AREA INTERNA
scala 1:25

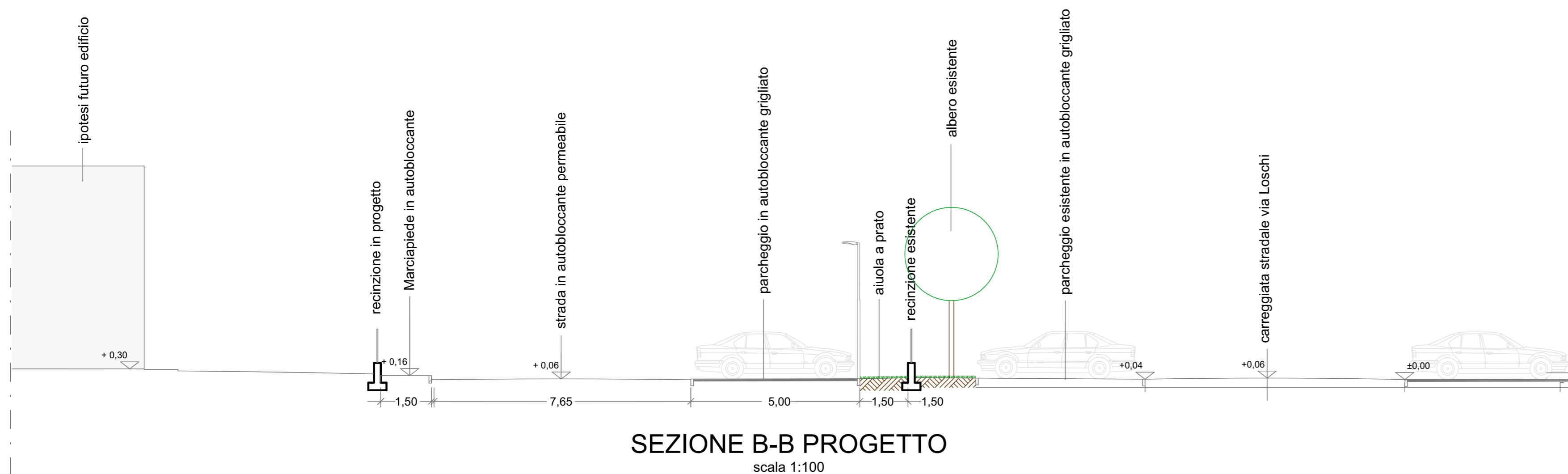

SEZIONE B-B PROGETTO
scala 1:100

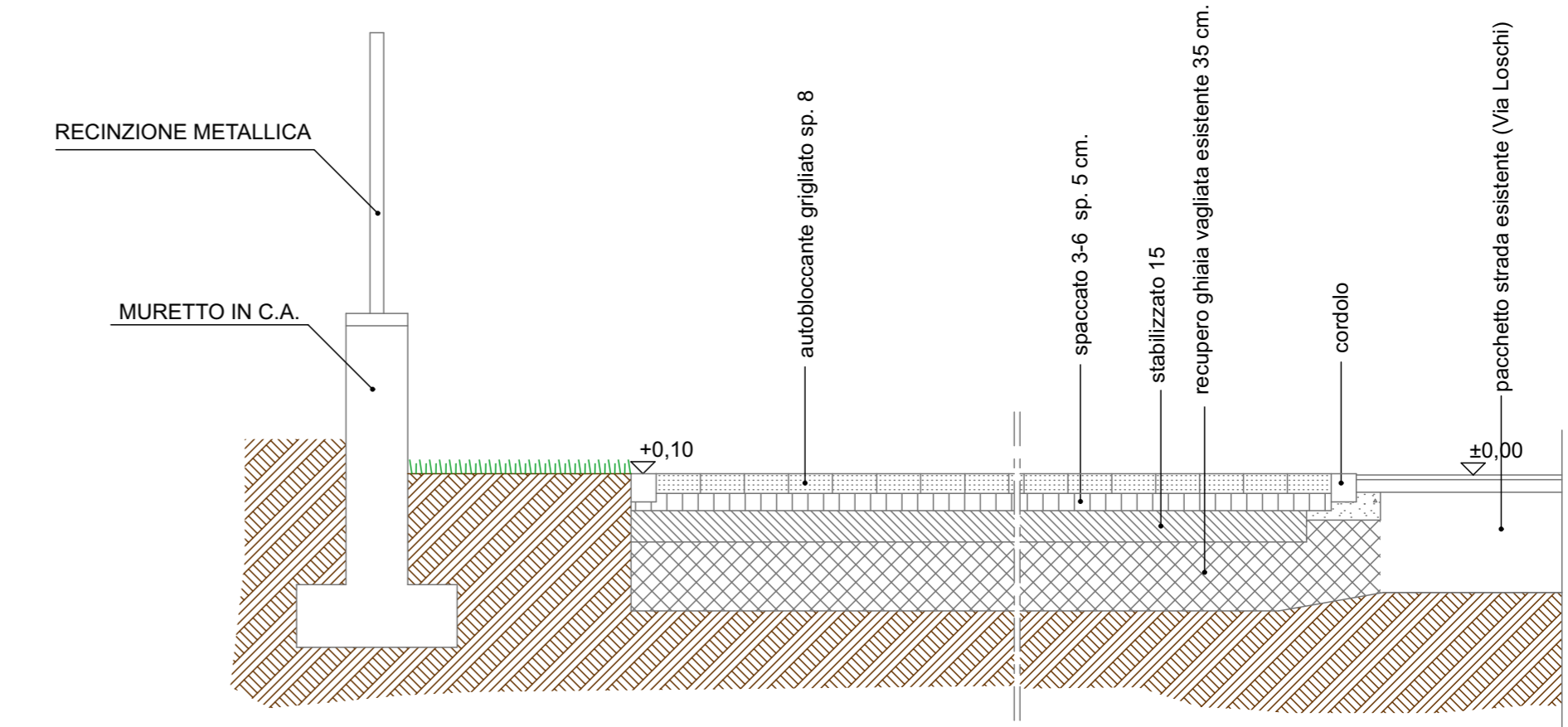

PARCHEGGI ESTERNI
scala 1:25